

8 7 6 5 4 3 2 1

D

C

B

A

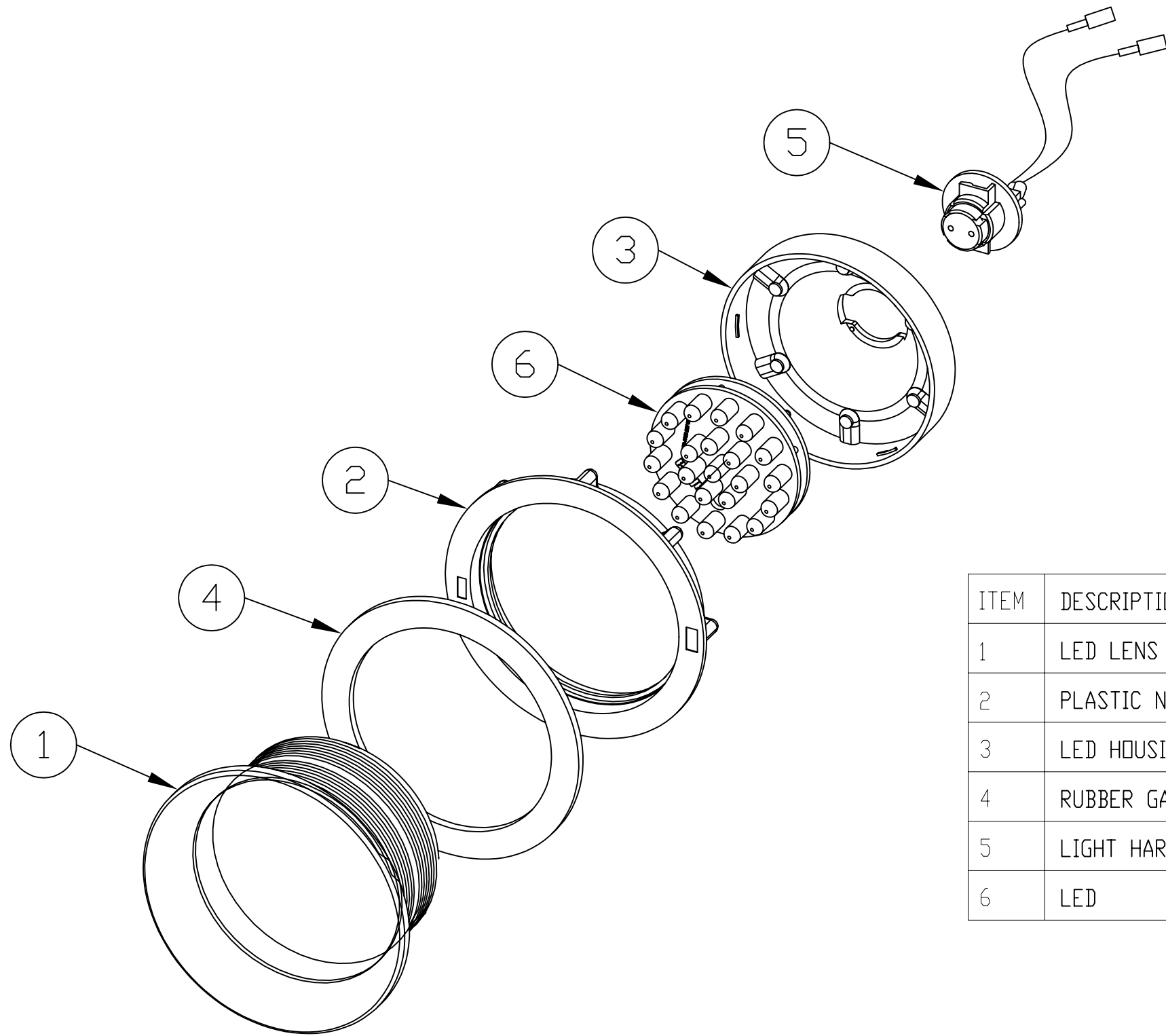

ITEM	DESCRIPTION	PRODUCTION PART	WARRANTY PART
1	LED LENS	9AU5009	THU5117
2	PLASTIC NUT	9AU5010	
3	LED HOUSING	9AU5011	
4	RUBBER GASKET	9AU5012	
5	LIGHT HARNESS	9AU5013	
6	LED	THU5116	

DRAWING STATUS: DRAFT1

PROPRIETARY AND CONFIDENTIAL  
 THE INFORMATION CONTAINED IN THIS  
 DRAWING IS THE SOLE PROPERTY OF  
 TOTO U.S.A., INC. ANY  
 REPRODUCTION IN PART OR AS A WHOLE  
 WITHOUT THE WRITTEN PERMISSION OF  
 TOTO U.S.A., INC. IS  
 PROHIBITED.

		UNLESS OTHERWISE SPECIFIED: DIMENSIONS ARE IN INCHES TOLERANCES: FRACTIONAL ± ANGULAR: MACH ± BEND ± TWO PLACE DECIMAL ± THREE PLACE DECIMAL ±	NAME <b>FRED KIRKSEY</b>	DATE <b>6/5/08</b>	TOTO USA INC. MORROW		
		INTERPRET GEOMETRIC TOLERANCING PER:	DRAWN		TITLE: <b>AIRBATH PARTS EXPLODED VIEW</b>		
		MATERIAL	CHECKED				
		FINISH	ENG APPR.				
			MFG APPR.				
NEXT ASSY	USED ON		Q.A.		SIZE DWG. NO. REV <b>B LED A</b>		
APPLICATION		DO NOT SCALE DRAWING	COMMENTS:				
					SCALE:	WEIGHT:	SHEET 1 OF 1

8 7 6 5 4 3 2 1

D

C

B

A